



THE LATIN PATRIARCHATE
OF JERUSALEM

Conclusion Report

School Playground Rehabilitation in Jifna, palestine

GA 235/20



General Administration
Project Development Department
October 2021

School Playground Rehabilitation in Jifna, palestine

“May we always care for our children, not counting the cost”

(H.H. Pope Francis)

Background

Jifna is a historic village nestled in the valley below Birzeit. It has a population of 2,150, the majority of them are Christians, which has been the case ever since the 6th century CE. The village is just 8km north of Ramallah, and its proximity to the university town of Birzeit has also helped it prosper in recent years.

The Latin Patriarchate School of Jifna was established in 1856, providing education opportunities to generations after generations in the area. The school is committed to ensuring that all students graduate with the knowledge and skills required to succeed as contributing citizens in the 21st century.



Project Description

The Latin Patriarchate and the Latin Patriarchate School administration believe that through play, children can break down barriers and grow friendships which contributes to the cognitive, physical, social, and emotional well-being of children and youth, that's why LPJ seeks to create age-friendly places, and inclusionary play spaces focused on health, fitness and sustainability. The Latin Patriarchate School of Jifna lacks a proper and safe outdoor space for the school students to play, partake in sports and bond. The old playground was inadequate, outdated, and had safety concerns. Building and rehabilitating an accessible playground would allow children to have a safe space to play outdoors with their peers, build friendships and simply be kids. The existing playground would no longer be used, and the new playground was moved to a new location adjacent to the school building. The new, revitalized playground would improve student safety, family satisfaction, student morale, and student physical activity levels. It will become a space that provides the opportunity for the children to practice an active lifestyle, safely engage in recreational opportunities, and encourage social interaction amongst peers.

Beneficiaries

The new playground will enrich the lives of 103 children (58% males, 45% females), which is the total number of the Latin Patriarchate school students in Jifna . It will also be used by the school and the community to organize sports activities and matches.

Activities Completed

- Preparing the location for the new playground, which included clearing and preparing the grounds (weeding, extracting stones and removing dirt, etc.)
- Asphalting and rehabilitating the ground
- Painting some of the walls or existing structures
- Installing a canopy to protect against weather conditions
- Safety has been ensured across the playground through the installation of fences
- Electrical and mechanical works

The project was completed in one month.

Photos - Before & During



Photos - After

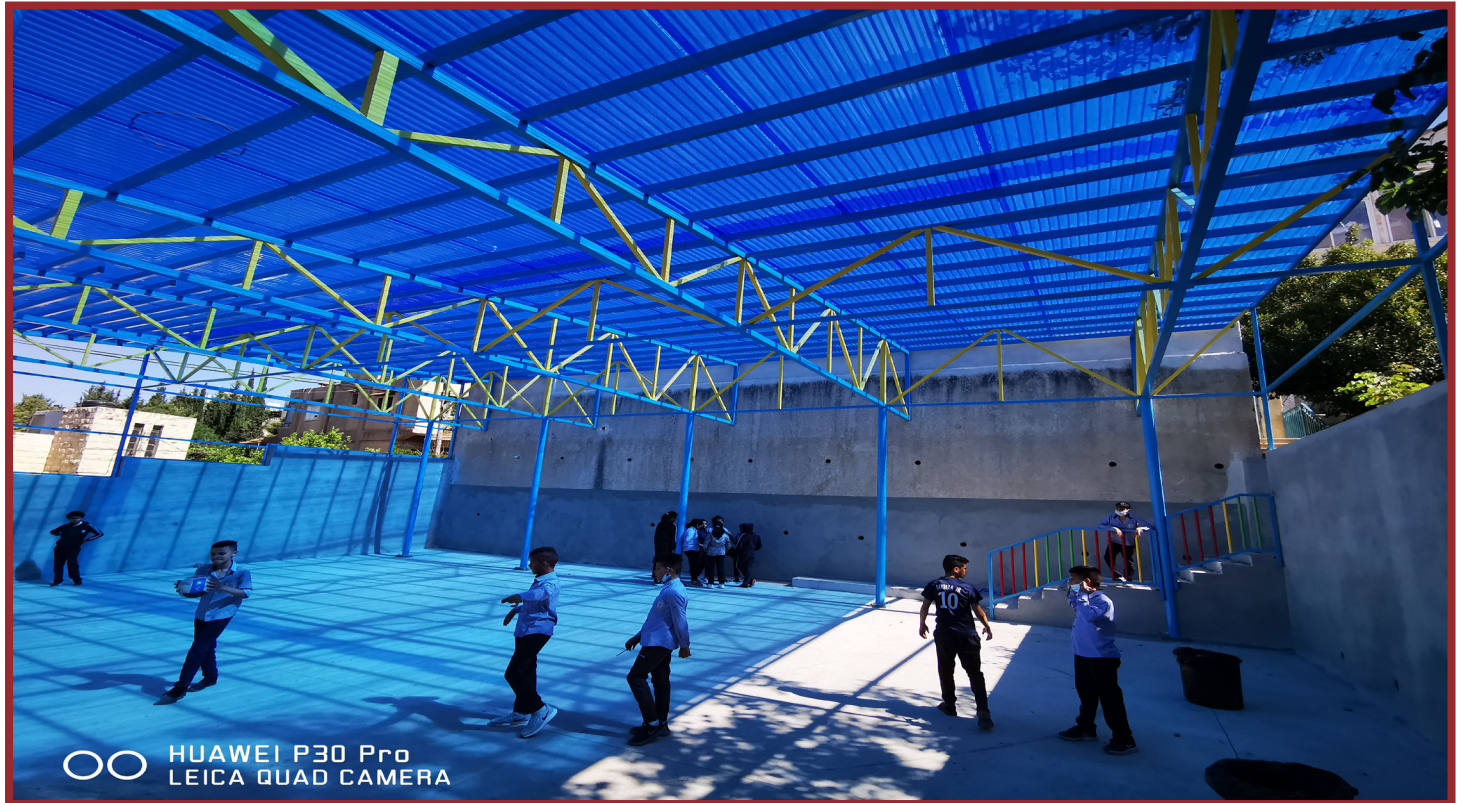



LATIN PATRIARCHATE
OF JERUSALEM

Sami El-Yousef
Chief Executive Officer

General Administration Office
Jaffa Gate, P.O. Box 14152
Jerusalem 9114101
Tel. + 972 2 6282323
E-mail: ceo@lpj.org
www.lpj.org

